

P100



SUCTION CUP WITH CELLULAR RUBBER PROFILE

- ▶ Suitable for irregular and rough surfaces.
- ▶ Use a ball joint if prone to bending.
- ▶ Available with adjustable support for handling thin material. Also suitable for applications requiring accurate positioning.
- ▶ Can also be equipped with a cone valve.

LIFTING FORCES & TECHNICAL DATA

Lifting force vertical to the surface, N, at vacuum level			Lifting force parallel to the surface, N, at vacuum level			Volume cm ³	Min. curve radius mm	Max. vertical movement mm	Weight with fitting g
20 -kPa	60 -kPa	90 -kPa	20 -kPa	60 -kPa	90 -kPa				
180	450	660	—	—	—	55	—	3.0	236

MATERIAL SPECIFICATIONS

Material	Colour	Hardness °Shore A	Temperature range °C
Ethylene propylene, EPDM	Grey	—	-40–100

MATERIAL RESISTANCE

Wear resistance	Oil	Weather & Ozone	Hydrolysis	Petrol	Concentrated acids	Alcohol	Oxidation
Fair	Poor	Excellent	Good	Poor	Poor	Excellent	Excellent

ORDERING INFORMATION

Complete suction cups		Art. No.
A	Suction cup P100 Ethylene propylene, G1/2" female	3350047
B	Suction cup P100 Ethylene propylene, G1/2" female, with cone valve	3350040
B	Suction cup P100 Ethylene propylene, G1/2" female, adjustable support with filter	3350037

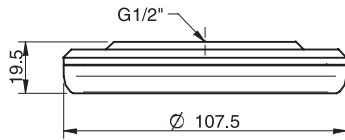

A

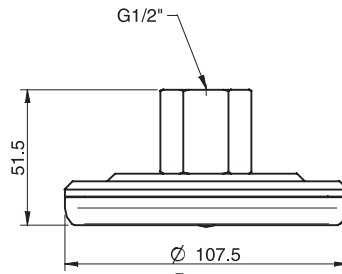

B

Rubber parts		Art. No.
Suction cup P100 Ethylene propylene		3350025
Fittings & accessories		Art. No.
Fitting G1/2" female		3350115
Adjustable support for P100, with filter		3350032
Cone valve for P100		3350058

Suction cups
P